

LOW VOLTAGE CONTACTORS LT1-D/HK

Documents corresponding to the product:
Standard EN 60947-1; EN 60 947-4-1



LOW VOLTAGE CONTACTORS LT1 D

5+2 standard +extended 7 YEAR TOTAL WARRANTY *for industrial usage, 3 years warranty

LT 1 D contactors are alternating current contactors for control of circuits and consumers operating in class AC3. It is suitable for consumers with rated current up to 95A. The contactors are offered in a type with 1 NO contact for operating circuit making and the models over 40A also have 1NC operating contactor.

FUNCTIONS:

- switching on/off heavy-loaded electrical circuits at controlling signal to the coil
- making of control systems
- used as an operating element in process control panels
- remarkable with high reliability of current characteristics
- reliable separation of power contactors
- secured cover of the movable part of the contactor

TECHNICAL DATA:

- Operation class: utilization category AC-3
- Rated operating voltage of power contactors: up to 690V; 50/60Hz
- Composition of the power contact surfaces: unalloyed copper with coating 80% AgSnO
- Surge voltage wear resistance: >8000V
- Rated voltage of the coil: from 12 to 400V AC

- Coil material: pure copper type QA-1
- Magnetic core material: alloy steel type 360
- Moveable part material: Bakelite
- Limits of the controlling coil voltage: operating range of coil
- Joining terminal: screw terminal
- Connecting:
 - flexible conductors with or without cable terminal
 - rigid conductors
- Electrical wear resistance (number of cycles): ≥1000000
- Mechanical wear resistance (number of cycles): ≥10000000
- Number of cycles per hour: 1200 UP TO 32A; 600 for 40-95A
- Pole leaking power: up to 13W

MOUNTING:

- on DIN-rail
- with bolts to the surface
- mounting position: vertical gradient – maximum ± 5°
- Plastic: wear resistance of UV rays and non-flammable (self-extinguishing material)
- Ambient temperature: -10°C + 65°C
- Altitude: up to 2000m



Type

Overall dimensions (mm)

	a	b	Ø	A	B	C
LT1-HK 06~12/LT-1K	34/35	45	4.5	45	50	50
LT-D 09~12	34/35	50/60	4.5	47	70	82
LT1 D18	34/35	50/60	4.5	47	70	87
LT1 D25	40	48	4.5	57	80	95
LT1 D32	40	48	4.5	57	80	100
LT-D 40~65	40	100/110	6.5	77	126	116
LT-D 80~95	40	100/110	6.5	87	126	127

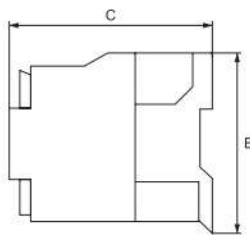

LT1-D 09~32
LT1 - K

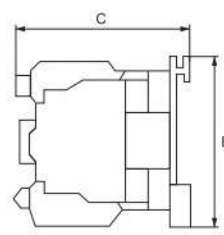
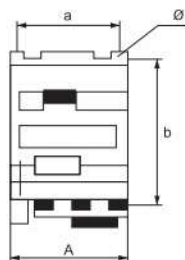

LT-D 95~40

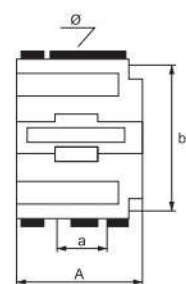

Type number	Rated capacity (kW)						Power consumption of coil (VA)		Rated current in AC-3 440V (N.m)	Tightening moment to up (N.m)	Section of the power supply conductor	Packing/ Box (pcs)	Product category	Catalogue number according to the coil voltage (V)						
	220V 230V	380V 400V	415V	440V	660V 690V	closed inrush	open hold	230V						400V	12V	24V	36V	48V	110V	
LT 1 - HK 0610 1NO	1.5	2.2	2.2	2.2	3	7	60	6A	1.7	0.75-2.5	1 / 100	B	23061E	23062E	23063E	23064E	23065E	23066E	23067E	
LT 1 - HK 0910 1NO*	2.2	3.7	3.7	3.7	4	7	60	9A	1.7	0.75-2.5	1 / 100	F	23091E	23092E		23094E	23095E	23096E	23097E	
LT 1 - HK 1210 1NO*	3	4	4	4	5	7	60	12A	1.7	0.75-2.5	1 / 100	F	23121E	23122E			23125E	23126E	23127E	
LT 1 - HK 0610 1NO*	1.5	2.2	2.2	2.2	3	7	60	6A	1.7	0.75-2.5	1 / 100	F		23062	23063		23065	23066	23067	
LT1 - D0910 1NO	2.2	4	4	4	5.5	7	60	9A	1.7	1-4	1 / 50	B	23091	23092	23093	23094	23095	23096	23097	
LT1 - D0901 1NC	2.2	4	4	4	5.5	7	60	9A	1.7	1-4	1 / 50	B	23273	23270	23271	23272	23277	23278	23279	
LT1 - D1210 1NO	3	5.5	5.5	5.5	7.5	7	60	12A	1.7	1-4	1 / 50	B	23121	23122	23123	23124	23125	23126	23127	
LT1 - D1201 1NC	3	5.5	5.5	5.5	7.5	7	60	12A	1.7	1-4	1 / 50	B	23274	23280	23281	23282	23283	23284	23285	
LT1 - D1810 1NO	4	7.5	9	9	10	7	60	18A	1.7	1-4	1 / 50	B	23181	23182	23183	23184	23185	23186	23187	
LT1 - D1801 1NC	4	7.5	9	9	10	7	60	18A	1.7	1-4	1 / 50	B	23275	23286	23287	23288	23289	23290	23291	
LT1 - D2510 1NO	5.5	11	11	11	15	7.5	90	25A	2.5	2.5-10	1 / 50	B	23251	23252	23253	23254	23255	23256	23257	
LT1 - D2501 1NC	5.5	11	11	11	15	7.5	90	25A	2.5	2.5-10	1 / 50	B	23276	23292	23293	23294	23295	23296	23297	
LT1 - D3210 1NO	7.5	15	15	15	18.5	7.5	90	32A	2.5	2.5-10	1 / 50	B	23321	23322	23323	23324	23325	23326	23327	
LT1 - D4011 1NO+1NC	11	18.5	22	22	30	20	200	40A	5	2.5-16	1 / 20	B	23401	23402	23403	23404	23405	23406	23407	
LT1 - D5011 1NO+1NC	15	22	25	25	33	20	200	50A	5	6-25	1 / 20	B	23501	23502	23503	23504	23505	23506	23507	
LT1 - D6511 1NO+1NC	18.5	30	37	37	37	20	200	65A	5	6-25	1 / 20	B	23651	23652	23653	23654	23655	23656	23657	
LT1 - D8011 1NO+1NC	22	37	45	45	45	20	200	80A	9	10-50	1 / 15	B	23801	23802	23803	23804	23805	23806	23807	
LT1 - D9511 1NO+1NC	25	45	45	45	45	20	200	95A	9	10-50	1 / 15	B	23951	23952	23953	23954	23955	23956	23957	

Note: *Until supply last - 3 year standard+0 year extended warranty

Documents corresponding to the product:
Standard EN 60947-1; EN 60 947-4-1

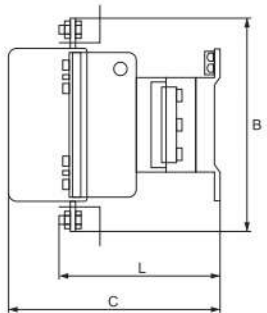
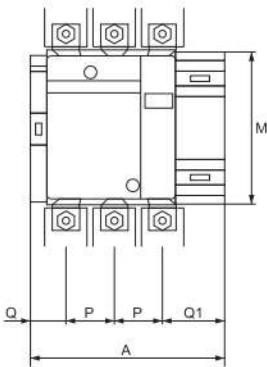

LOW VOLTAGE CONTACTORS LT1 F



The contactors LT 1- F are alternating current contactors used to control circuits and consumers operating in normal working conditions with switching on /off the consumer and dirty working environment. They are suitable for consumers with electrical power consumption from 115A to 800A.

FUNCTIONS:

- frequently switching on/off heavy-loaded electrical circuits at controlling signal to the coil
- making of systems for consumers' control
- used as an operating element in process control panels
- remarkable with high reliability of current characteristics
- reliable separation of power contactors
- secured cover of the movable part of the contactor

TECHNICAL DATA:

- Operation class: utilization category AC-3
- Rated operating voltage of power contactors: up to 1000V; 50/60Hz
- Composition of the power contact surfaces: unalloyed copper with coating 80% AgSnO
- Surge voltage wear resistance: >8000V
- Coil composition: pure coil copper QA-1 type
- Magnetic core composition: steel alloy 360

- Movable part composition: bakelite
- Limits of the controlling coil voltage: operating range of coil
- Joining terminal: screw terminal
- Connecting:
 - ↳ flexible conductors with or without cable terminal
 - ↳ rigid conductors
 - ↳ rail
- Electrical wear resistance (number of cycles) ≥ 10000000
- Mechanical wear resistance (number of cycles) ≥ 10000000
- Number of cycles (switching on) per hour: 200
- Pole leaking power: from 16 to 80W
- Mounting:
 - ↳ with bolts to the surface
 - ↳ mounting position: vertical gradient – maximum ± 10°C
- Plastic: wear resistance of UV rays and non-flammable (self-extinguishing material)
- Ambient temperature: -10°C + 65°C
- Altitude: up to 2000m

Type	Overall dimensions (mm)							
	A	B	C	L	M	Q	Q1	P
LT 1 F150	163.5	170	171	107	150	26	57.5	40
LT 1 F225	168.5	197	181	113.5	172	21	51.5	48
LT 1 F265	201.5	203	181	141	178	39	66.5	48
LT 1 F400	213	206	219	145	182	43	74	48
LT 1 F630	309	304	255	155	264	60	89	80
LT 1 F800	309	304	255	155	264	60	89	80

Type number	Motor rated capacity (kW)							Power consumption of coil (VA)		Rated current in AC-3 440V(N.m) to up	Tightening moment	Packing/ Box (pcs)	Product category	Catalogue number according to the coil voltage (V)					
	220V 230V	380V 400V	415V	440V	500V	660V 690V	1000V	closed	open					230V	400V	24V*	36V	48V	110V
LT1 - F115	30	55	59	59	59	80	60	45	550	115 A	18	1 / 4	B	23111	23112	23114	23115	23116	23117
LT1 - F150	40	75	80	80	90	100	65	45	550	150 A	25	1 / 4	B	23151	23152		23155	23156	23157
LT1 - F225	63	110	110	110	129	129	100	55	805	225 A	35	1 / 2	B	23861	23862		23865	23866	23867
LT1 - F265	75	132	140	140	160	160	147	10	700	265 A	35	1 / 2	B	23261	23262		23265	23266	23267
LT1 - F400	110	200	220	250	257	280	185	18	1000	400 A	50	1 / 1	B	23751	23752				
LT1 - F630	200	335	375	400	400	450	450	25	1500	630 A	50	1 / 1	B	23771	23772				
LT1 - F800	250	450	450	450	450	475	450	15	1300	800 A	50	1 / 1	B	23881	23882				

Note: At mounting the containers from the series in control schemes a distance must be provided at the side of the contactor in case of eventual coil change.

*Until Supply Last- Product category F

Documents corresponding to the product:
Standard EN60947-1; EN 60947-4-1

LOW VOLTAGE CONTACTORS WITH DIRECT CURRENT COIL LP-D

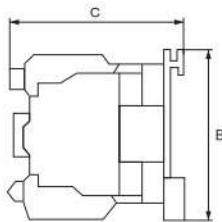
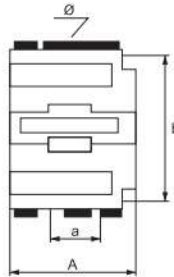

LP1-D 09~95

The contactors LP1 D are alternating current contactors with DC operating of coil for control. The power plugs of the contactor are designed for control of alternating current circuits and consumers operating in normal operating class AC-3 with frequently switching on/off the consumer and dirty working environment. The contactors are suitable for consumers with electrical power consumption from 9A to 225A.

FUNCTIONS:

- switching on/off alternating current consumers in direct current controlling schemes at controlling signal to the coil
- making of systems for consumers' control
- used as an operating element in process control panels
- remarkable with high reliability of current characteristics
- reliable separation of power contacts
- secured cover of the movable part of the contactor

TECHNICAL DATA:

- Rated operating voltage of the coil: from 12V DC to 220V DC
- Rated operating voltage of the power circuit: up to 690V DC
- insulation voltage: 690V

- Surge voltage wear resistance: >8000V
- Limits of the controlling coil voltage: operating range of coil
- Joining terminal: screw terminal
- Connecting:
 - ↳ flexible conductors with or without cable terminal
 - ↳ rigid conductors
- Electrical wear resistance (number of cycles) ≥ 10000000
- Mechanical wear resistance (number of cycles) ≥ 10000000
- Number of cycles per hour: 1200 up to 32A; 600 for 40-95A
- Pole leaking power: up to 13W

MOUNTING:

- on DIN-rail
- with bolts to the surface
- mounting position: vertical gradient – maximum ± 5°
- Plastic: wear resistance of UV rays and non-flammable (self-extinguishing material)
- Ambient temperature: -10°C + 65°C
- Altitude: up to 2000m

Type	Overall dimensions (mm)				
	A	B	C	a	b
LP 1 D0910	47	76	95	34/35	50/60
LP 1 D1210	47	76	95	34/35	50/60
LP 1 D1810	47	76	95	34/35	50
LP 1 D2510	57	86	101	40	50
LP 1 D3210	57	86	101	40	50
LP 1 D4011	77	129	176	40	100
LP 1 D5011	77	129	176	40	100
LP 1 D6511	77	129	176	40	100
LP 1 D9511	87	129	182	40	100
LP 1 F115	163.5	170	171	40	150
LP 1 F150	163.5	170	171	40	150
LP 1 F225	168.5	197	181	48	172

Type	Rated current (A)	Auxiliary contact (pcs.)	Rated capacity of the consumer (kW)					Packing/Box (pcs)	Product category	Catalogue number according to the coil voltage (V DC)					
			230V	400V	415V	440V	690V			12V	24V	36V	48V	110V	230V
LP 1 D0910	9	1NO	2.20	4.00	4.00	4.00	5.50	1/40	B	23962	23098	23130	23971	23980	23139
LP 1 D1210	12	1NO	3.00	5.50	5.50	5.50	7.50	1/40	B	23963	23128	23131	23972	23981	23140
LP 1 D1810	18	1NO	4.00	7.50	7.50	7.50	10.0	1/30	B	23964	23188	23132	23973	23982	23141
LP 1 D2510	25	1NO	5.50	11.0	11.0	11.0	15.0	1/20	B	23925	23258	23133	23974	23983	23142
LP 1 D3210	32	1NO	7.50	15.0	15.0	15.0	18.5	1/30	B	23966	23328	23134	23975	23984	23143
LP 1 D4011	40	1NO+1NC	11.0	18.5	18.5	18.5	30.0	1/10	B	23967	23408	23135	23976	23985	23144
LP 1 D5011	50	1NO+1NC	15.0	22.0	22.0	22.0	33.0	1/10	B	23968	23508	23136	23977	23986	23145
LP 1 D6511	65	1NO+1NC	18.5	30.0	30.0	30.0	37.0	1/10	B	23969	23658	23137	23978	23987	23146
LP 1 D9511	95	1NO+1NC	25.0	45.0	45.0	45.0	45.0	1/10	B	23970	23958	23138	23979	23988	23147
LP 1 F115	115	1NO	30.0	55.0	59.0	59.0	80.0	1/4	B		23118*	23914	23917	23989	23148
LP 1 F150	150	1NO	40.0	75.0	80.0	80.0	100	1/4	B		23158*	23915	23918	23990	23149
LP 1 F225	225	1NO	63.0	110	110	110	129	1/2	B			23916	23919	23994	23201

Documents corresponding to the product:
Standard EN60947-1; EN 60947-4-1

LOW VOLTAGE CONTACTORS FOR SWITCHING ON OF CAPACITOR BANKS CJ19-43

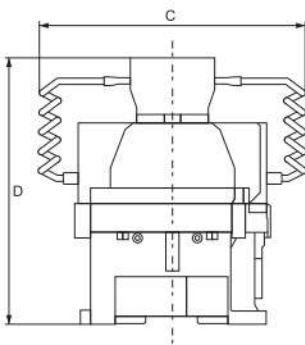
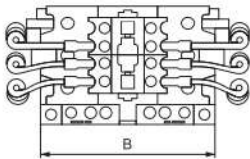
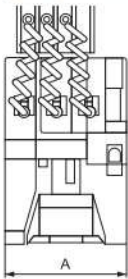

The AC contactors CJ19-43 are specially designed electrical devices for commutation of three phase capacitors used for power correction. They are alternating current contactor LT1 Dxx with mounted a group for peak current lowering from the transitional process of the capacitor's switching on/off. This group is a combination of current limiting resistors, switched on in the beginning of the transitional process (switching on/off of the capacitor group). The contactors are suitable for capacitors with rate up to 50 kVAr.

FUNCTIONS:

- switching on/off of capacitor banks for reactive power compensation
- making of systems for compensation of the energy reactive component
- lowering of the peak transitional currents at switching on/off of the capacitor
- remarkable with high reliability of current characteristics
- reliable separation of power contacts
- secured part of the contactor against consumer contact
- do not allow manual operation

TECHNICAL DATA:

- Operation class: utilization category AC6b
- Rated operating voltage of the controlling coil: 230V

AC; 50/60Hz

Rated operating voltage of the power circuit: up to 690V AC

insulation voltage: 690V

Surge voltage wear resistance: >8000V

Limits of the controlling coil voltage: from 0.8 to 1.15 U_c

Number of the contacts: 3 NO power contacts +1NO operative

Joining terminal: screw terminal

Connecting:

- flexible conductors with or without cable terminal
- rigid conductors

Electrical wear resistance (number of cycles): ≥300000

Mechanical wear resistance (number of cycles): ≥1000000

Number of cycles (switching on) per hour: up to 600

Pole leaking power: up to 13W

MOUNTING:

- on DIN-rail or with bolts to the surface
- mounting position: vertical gradient – maximum ± 5°
- Plastic: wear resistance of UV rays and non-flammable (self-extinguishing material)
- Ambient temperature: -10°C + 65°C
- Altitude: up to 2000m

Type	Overall dimensions (mm)			
	A	B	C	D
CJ19-32 DPK	56	74	130	150
CJ19-40 DPK	75	127	180	150
CJ19-65 DPK	85	127	200	157
CJ19-95 DPK	85	127	200	157
CJ19-115DPK	122	165	230	157
CJ19-150DPK	122	165	230	157
CJ19-170DPK	122	165	230	157

Type	Rated current (A)	Rated capacity of the consumer (kVA _r)		Coil voltage (V)	Packing/Box (pcs)	Product category	Catalogue category number
		400/440V	690V				
CJ19-32 DPK	32	8	12.5	230	1/20	B	23932
CJ19-32 DPK	32	8	12.5	400	1/20	B	23910
CJ19-40 DPK	40	12.5	15	230	1/16	B	23900
CJ19-40 DPK	40	12.5	15	400	1/16	B	23940
CJ19-65 DPK	65	25	30	230	1/16	B	23961
CJ19-65 DPK	65	25	30	400	1/16	B	23965
CJ19-95 DPK	95	30	36	230	1/16	B	23909
CJ19-95 DPK	95	30	36	400	1/16	B	23995
CJ19-115 DPK	115	35	40	230	1/4	B	23991
CJ19-150 DPK	150	40	50	230	1/4	B	23992
CJ19-170 DPK	170	50	60	230	1/4	B	23993

Documents corresponding to the product:
Standard EN60947-1; EN 60947-4-1

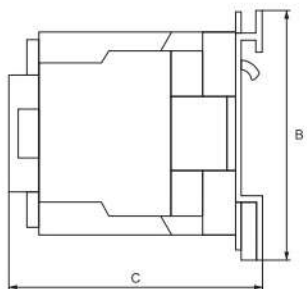
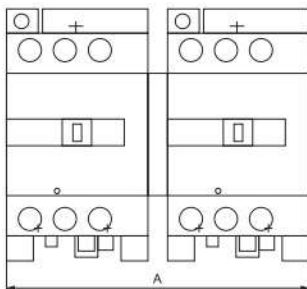

Type	Overall dimensions (mm)		
	A	B	C
LT 4 - D1810	100	70	83
LT 4 - D2510	130	80	98
LT 4 - D3210	130	80	105
LT 4 - D4011	167	126	116
LT 4 - D6511	167	126	116
LT 4 - D9511	182	127	127

REVERSE CONTACTORS LT4-DXX

5+2
standard
+extended **7** YEAR TOTAL WARRANTY *for industrial usage, 3 years warranty

LT 4-Dxx series contactors is suitable for across-the line starting and reversing of 3 phase squirrel cage and slip ring motors. It consist of two magnetic contactors LT1D. The contactor is provided with a built-in interlock safety mechanism. The contactor is used for reverse control of induction motors with shorty rotor. The contactors from the series are offered for consumers up to 95A.

FUNCTIONS:

- switching on of electrical motors in one direction of rotation and reversing of the rotation direction at outside command
- making of control systems
- remarkable with high reliability of current characteristics
- reliable switching on or separation of power contacts
- secured part of the contactors against consumer contact
- secured cover of the movable part of the contactor
- impossibility for simultaneous switching on of the two contactors from the group due to mechanical locking

TECHNICAL DATA:

- Operation class: AC 3
- Rated operating voltage of the controlling coil: 230V AC; 50/60 Hz
- Rated operating voltage of the power circuit: up to 690V AC

- insulation voltage: 690V
- Surge voltage wear resistance: >8000V
- Limits of the controlling coil voltage: from 0.8 to 1.15 U_c
- Number of plugs: 3 NO power contacts +1NO operative (for contactors over 40A there is also additional 1NC contact)
- Joining terminal: screw terminal
- Connecting:
 - ↳ flexible conductors with or without cable terminal
 - ↳ rigid conductors

NOTE: The contactors are offered without factory cabling

- Electrical wear resistance (number of cycles): ≥1 000 000
- Mechanical wear resistance (number of cycles): ≥10 000 000
- Number of cycles (switching on) per hour: up to 600
- Pole leaking power: up to 13W

MOUNTING:

- on DIN-rail or
- with bolts to the surface
- mounting position: vertical gradient – maximum ± 5°
- Plastic: wear resistance of UV rays and non-flammable (self-extinguishing material)
- Ambient temperature: -10°C + 65°C
- Altitude: up to 2000m

Type	Rated current (A)	Rated capacity of the consumer (kW)					Packing/Box (pcs)	Product category	Catalogue number
		230V	400V	415V	440V	690V			
LT 4 D1810	18	4	7.5	7.5	7.5	10	1 / 20	B	23301
LT 4 D2510	25	5.5	11	11	11	15	1 / 20	B	23302
LT 4 D3210	32	7.5	15	15	15	18.5	1 / 20	B	23303
LT 4 D4011	40	11	18.5	18.5	18.5	30	1 / 8	B	23304
LT 4 D6511	65	18.5	30	30	30	37	1 / 8	B	23305
LT 4 D9511	95	25	45	45	45	45	1 / 6	B	23306

TIME DELAY CONTACT BLOCK LT02-DXX

5+2
standard
+extended **7** YEAR TOTAL WARRANTY *for industrial usage, 3 years warranty



LT02-Dxx is designed to set time intervals from 0.1 to 180s in different control schemes. It is used most frequently in combination with contactors from LT1-Dxx series to form "star/delta" starters for electrical motor control, as it provides the necessary time for motor winding.

Type	Number of contacts	Time delay	Delay	Product category	Catalogue number
LT02-DT0	NO+NC	0.1~3s	ON	B	23901
LT02-DT2	NO+NC	0.1~30s	ON	B	23902
LT02-DT4	NO+NC	10~180s	ON	B	23903
LT02-DT22	NO+NC	0.1~30s	OFF	B	239022

Dimensions (mm)

W	W2	L1	h1	h2	H
33	45	48	22	14	59

Documents corresponding to the product:
Standard EN 60947-4-1

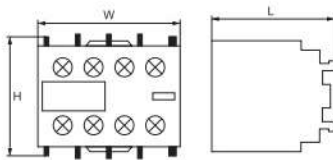

Dimensions (mm)

H	W	L	W1	W2
32	40	35	26	45
H2	L1	L2		
48	6,5	37		

AUXILIARY CONTACTS

5+2 standard +extended 7 YEAR TOTAL WARRANTY *for industrial usage, 3 years warranty

AUXILIARY CONTACTS

At necessity the element provide auxiliary number of contacts. They are specially designed for mounting on the movable part of the magnetic core of the contactors LT 1K/D series.

FUNCTIONS:

- extending the number of the operative contactors up to 4 in different
- Combinations
 - ↳ switches on simultaneously with the other contact system of the contactor
- Operation class: AC 3

insulation voltage: 690V

Joining terminal: screw terminal

Connecting:

- ↳ flexible conductors with or without cable terminal
- ↳ rigid conductors

MOUNTING:

- on the movable cover of the contactor through pinching
- mounting position: vertical gradient – maximum ± 5°
- Plastic: wear resistance of UV rays and non-flammable (self-extinguishing material)

Type	For Contactor Series	Number of contacts	Rated current	Section of the conductor (mm ²)	Product category	Catalogue number
LT01-DN02	LT1-D & LT1-F	2NC	6A	0,5-1	B	23002
LT01-DN11	LT1-D & LT1-F	NO+NC	6A	0,5-1	B	23011
LT01-DN20	LT1-D & LT1-F	2NO	6A	0,5-1	B	23020
LT01-DN22	LT1-D & LT1-F	2NO+2NC	6A	0,5-1	B	23022
LT01-DN40	LT1-D & LT1-F	4NO	6A	0,5-1	B	23040
LT01-DN04	LT1-D & LT1-F	4NC	6A	0,5-1	B	23004
LT01-KN11	LT1-HK	NO+NC	6A	0,5-1	B	23001
LT01-KN22	LT1-HK	2NO+2NC	6A	0,5-1	B	23003

AUXILIARY CONTACTS LT03-DN11

5+2 standard +extended 7 YEAR TOTAL WARRANTY *for industrial usage, 3 years warranty



Dimensions (mm)

W1	W2	H	L	A
73	48	22	12,5	72

Providing on necessity additional number of plug points and are mounted sideward to the movable part of the magnetic cores of contactors of the series LT1D till 65A. Variants with two additional plug points NO and NC are offered.

FUNCTIONS:

- expanding the number of the operational plug points
- switching on simultaneously with the rest of the contact system
- of the contactor

↳ flexible conductors with or without cable end
↳ solid conductors

• Mounting method:

↳ mounting position – sideward to the contactor

- Plastic: resistant to UV and non-burning (self-extinguishing material)

TECHNICAL CHARACTERISTICS:

- Environment operational regime: AC 3
- Insulation voltage: 690V
- Double connector: screw connector
- Connection:

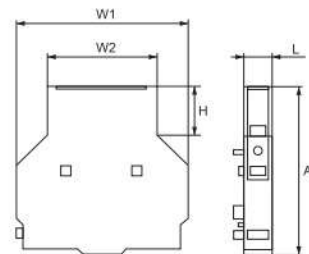

Type	Rated current	Section of the conductor (mm ²)	Product category	Catalogue number
LT03-DN11	6A	0,5-1	B	23311

Documents corresponding to the product:
Standard EN 61095

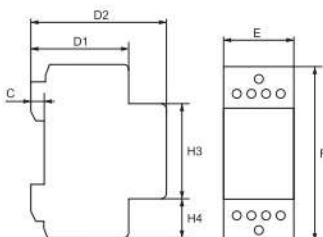
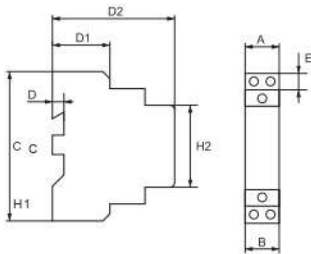

Dimensions (mm)

C	D1	D2	H3	H4
5	66	48	45	20
E	F			
35	85			

MODULE CONTACTORS K SERIES

5+2 standard + extended
7 YEAR TOTAL WARRANTY
*for industrial usage, 3 years warranty

Modular contactors K series are used for commutation of mono-phase and three-phase low power electrical consumers. They provide connection between the consumers in small overall dimensions, silent work, mounting only at DIN-rails.

FUNCTIONS:

- switching on of consumers
- making of control systems
- remarkable with high reliability of current characteristics
- reliable switching on or separation of power contacts

TECHNICAL DATA:

- Operation class: AC 7a
- Rated operating voltage of the controlling coil: 230V

AC; 50/60 Hz

- Rated operating voltage of the power circuit: up to 690V AC
- insulation voltage: 690V
- Surge voltage wear resistance: >8000V
- Joining terminal: screw terminal
- Connecting:
 - ↳ flexible conductors with or without cable terminal
 - ↳ rigid conductors

MOUNTING:

- on DIN-rail or
- mounting position: vertical gradient – maximum ± 5°
- Plastic: wear resistance of UV rays and non-flammable (self-extinguishing material)
- Ambient temperature: -10°C + 65°C
- Altitude: up to 2000m

Type	In	Coil voltage (V)	Contacts	Packing/Box (pcs)	Product category	Catalogue number
K20	20A	230V	2NO	1/12/120	B	23008
K20	20A	230V	NO+NC	1/12/120	B	23007
K20	20A	230V	2NC	1/12/120	B	23009
K20	25A	230V	NO+NC	1/12/100	B	23012
K20	25A	230V	2NO	1/12/100	B	23013
K20	25A	230V	2NC	1/10/100	B	23014
K20	40A	230V	NO+NC	1/6/60	B	23015
K20	40A	230V	2NO	1/6/60	B	23016
K20	40A	230V	2NC	1/6/60	B	23017
K20	100A	230V	2NO	1/4/40	B	23080
K20	100A	230V	1NO+1NC	1/4/40	B	23083
K20	100A	230V	2NC	1/4/40	B	23084
K40	25A	230V	2NO+2NC	1/6/60	B	23410
K40	25A	230V	3NO+1NC	1/6/60	B	23411
K40	25A	230V	4NO	1/6/60	B	23412
K40	25A	230V	4NC	1/6/60	B	23413
K40	40A	230V	2NO+2NC	1/4/40	B	23422
K40	40A	230V	3NO+1NC	1/4/40	B	23423
K40	40A	230V	4NO	1/4/40	B	23409
K40	40A	230V	4NC	1/4/40	B	23424
K40	63A	230V	2NO+2NC	1/4/40	B	23425
K40	63A	230V	3NO+1NC	1/4/40	B	23426
K40	63A	230V	4NO	1/4/40	B	23427
K40	63A	230V	4NC	1/4/40	B	23428
K40	80A	230V	4NO	1/2/20	B	23480
K40	80A	230V	2NO+2NC	1/2/20	B	23483
K40	80A	230V	4NC	1/2/20	B	23484
K40	80A	230V	3NO+1NC	1/2/20	B	23485

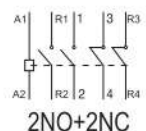
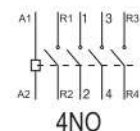
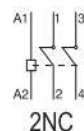
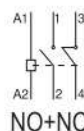
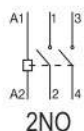

In case of insufficient quantity in stock of any item listed on this page, the delivery time after order confirmation will be 30 days.